

River Courses beg<sup>d</sup> Beech.

- N. 26. W. 20.5
- N. 58. W. 13
- N. 29. W. 35
- N. 23. W. 23
- N. 41. W. 13.5
- N. 33 1/2 W. 38
- N. 16 1/2 W. 43
- 186 P<sup>s</sup>

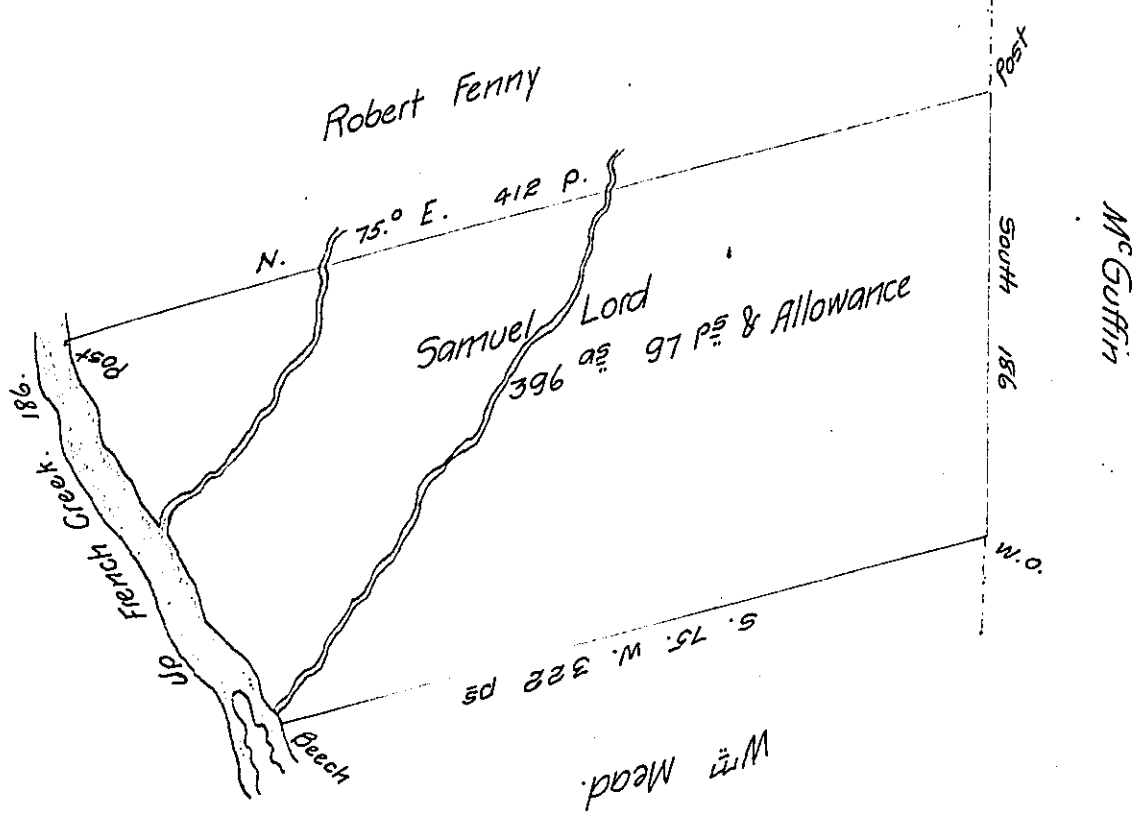

Situate in Allegheny County on the East Side of French Creek Containing three Hundred and Ninety Six acres and ninety Seven Perches and allowance of Six P Cent &c. Surveyed the 7<sup>th</sup> day of may 1794 In pursuance of his Improvement. dated the 1<sup>st</sup> day of Feb<sup>y</sup>. 1793.

W<sup>th</sup> Power D.Y. 5<sup>th</sup>

To Daniel Brodhead Esq<sup>r</sup> }  
 Surveyor General

IN TESTIMONY that the above is a copy of the original remaining on file in the Department of Internal Affairs of Pennsylvania, made conformably to an Act of Assembly approved the 16th day of February, 1833, I have hereunto set my Hand and caused the Seal of said Department to be affixed at Harrisburg, this.....tenth.....day of.....October.....1905

*[Signature]*  
 Secretary of Internal Affairs.